

C-3)

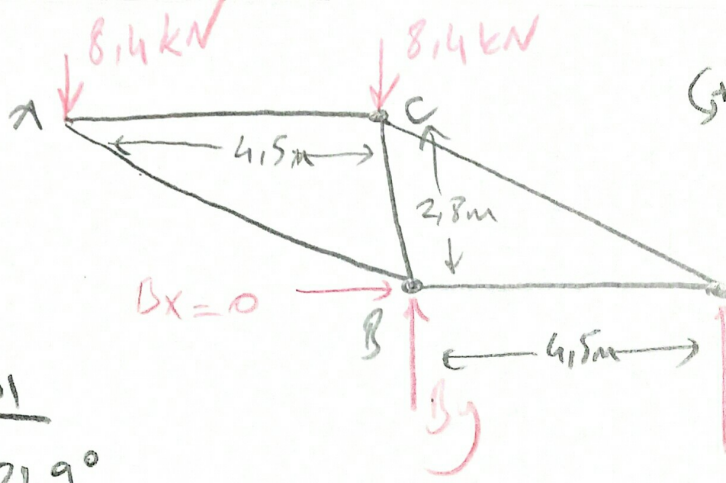

$$\begin{aligned}
 \sum M_B = 0 & \\
 &= 8,4 \cdot 4,5 + D_y \cdot 4,5 \\
 D_y &= -8,4 \text{ kN} = 8,4 \text{ kN}
 \end{aligned}$$

$$\begin{aligned}
 \sum M_D = 0 & \\
 &= 8,4 \cdot 4,5 + 8,4 \cdot 9 - B_y \cdot 4,5 \\
 B_y &= 25,2 \text{ kN}
 \end{aligned}$$

D node

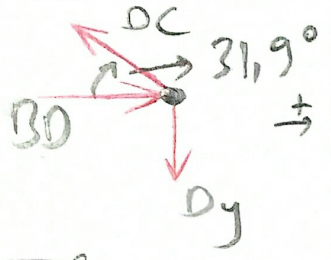

$$\begin{aligned}
 \sum F_x = 0 & \Rightarrow BD - DC \cdot \cos 31,9 = 0 \\
 \Rightarrow BD &= 0,85 DC
 \end{aligned}$$

$$\sum F_y = 0 \Rightarrow DC \cdot \sin 31,9 - D_y = 0$$

$$DC = 15,9 \text{ kN}, \Rightarrow BD = 13,5 \text{ kN}$$

B node

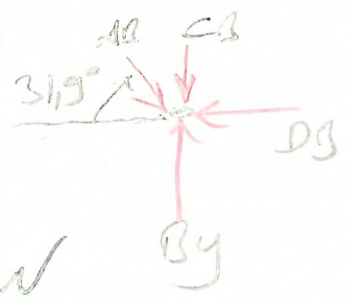

$$\sum F_x = 0 \Rightarrow DB - AB \cos 31,9 = 0 \Rightarrow AB = 15,9 \text{ kN}$$

$$\sum F_y = 0 \Rightarrow CB + AB \sin 31,9 - B_y = 0 \Rightarrow CB = 16,8 \text{ kN}$$

$$\sum F_x = 0 \Rightarrow AC + DC \cdot \cos 31,9 = 0 \Rightarrow AC = 13,5 \text{ kN}$$

C node

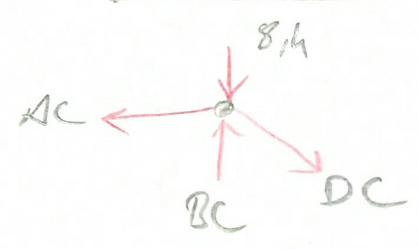

DC	BD	AB	CB	AC
15,9	13,5	15,9	16,8	13,5 (kN)